

Haus der Wirtschaft ↑

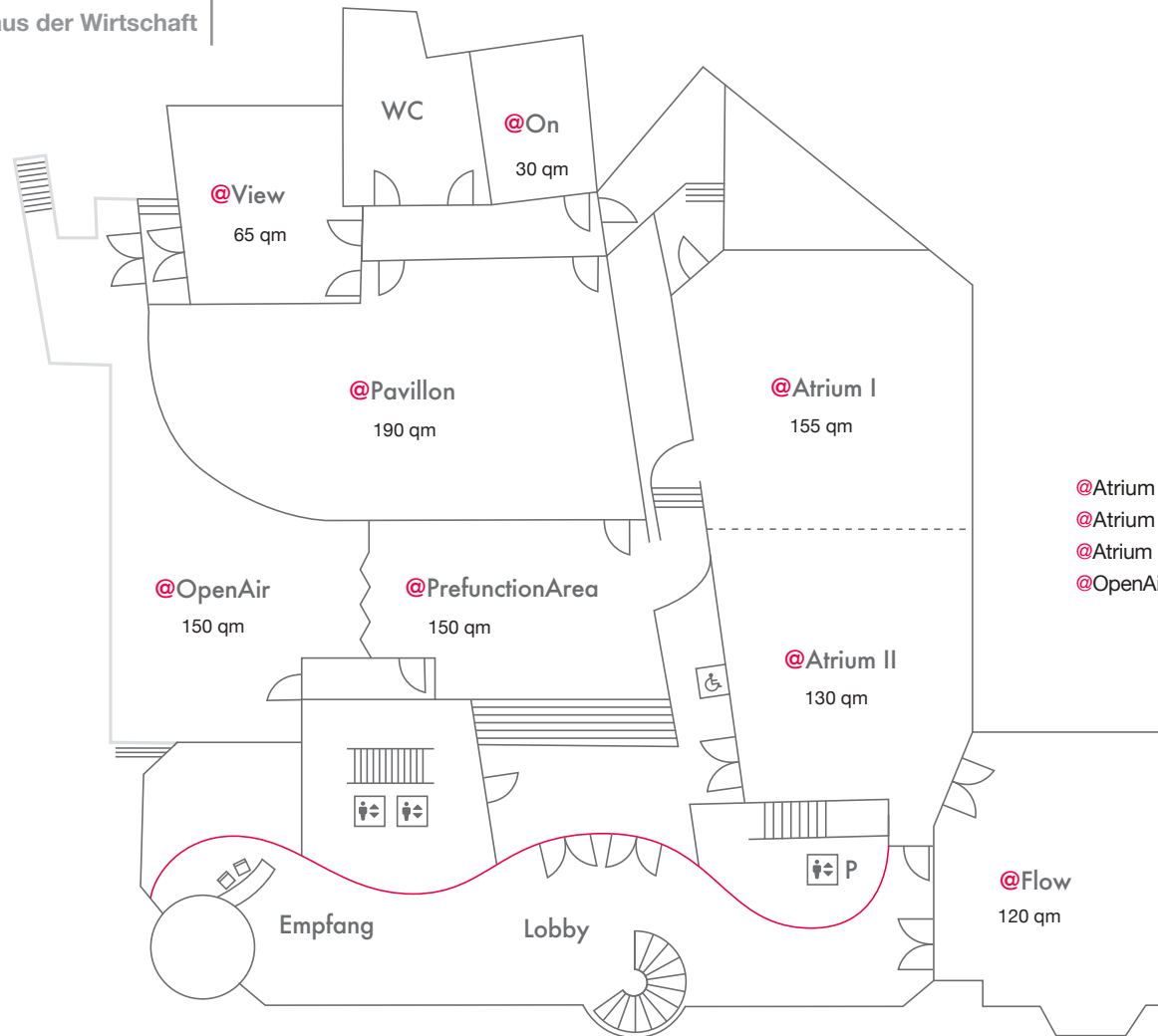

- @Atrium I + II: 285 qm
- @Atrium II + @Flow: 250 qm
- @Atrium I + II + @Flow: 405 qm
- @OpenAir + @PrefunctionArea: 300 qm

Theodor-Heuss-Straße 2

Raum	@View	@On	@Atrium I	@Atrium II	@Flow	@Atrium I + II	@Atrium II + @Flow	@Atrium I + II + @Flow	@Pavillon	@OpenAir	@Prefunction Area	@OpenAir + @PrefunctionArea
<b>1/2 Tag</b> max. 4 h, in der Zeit von 7.00h - 19.00h	€ 445	€ 330	€ 590	€ 480	€ 700	€ 1.015	€ 1.120	€ 1.681	€ 505	€ 300	€ 300	€ 570
<b>1 Tag</b> max. 8 h, in der Zeit von 7.00h - 19.00h	€ 800	€ 595	€ 1.060	€ 865	€ 1.260	€ 1.830	€ 2.015	€ 3.025	€ 910	€ 540	€ 540	€ 1.025